

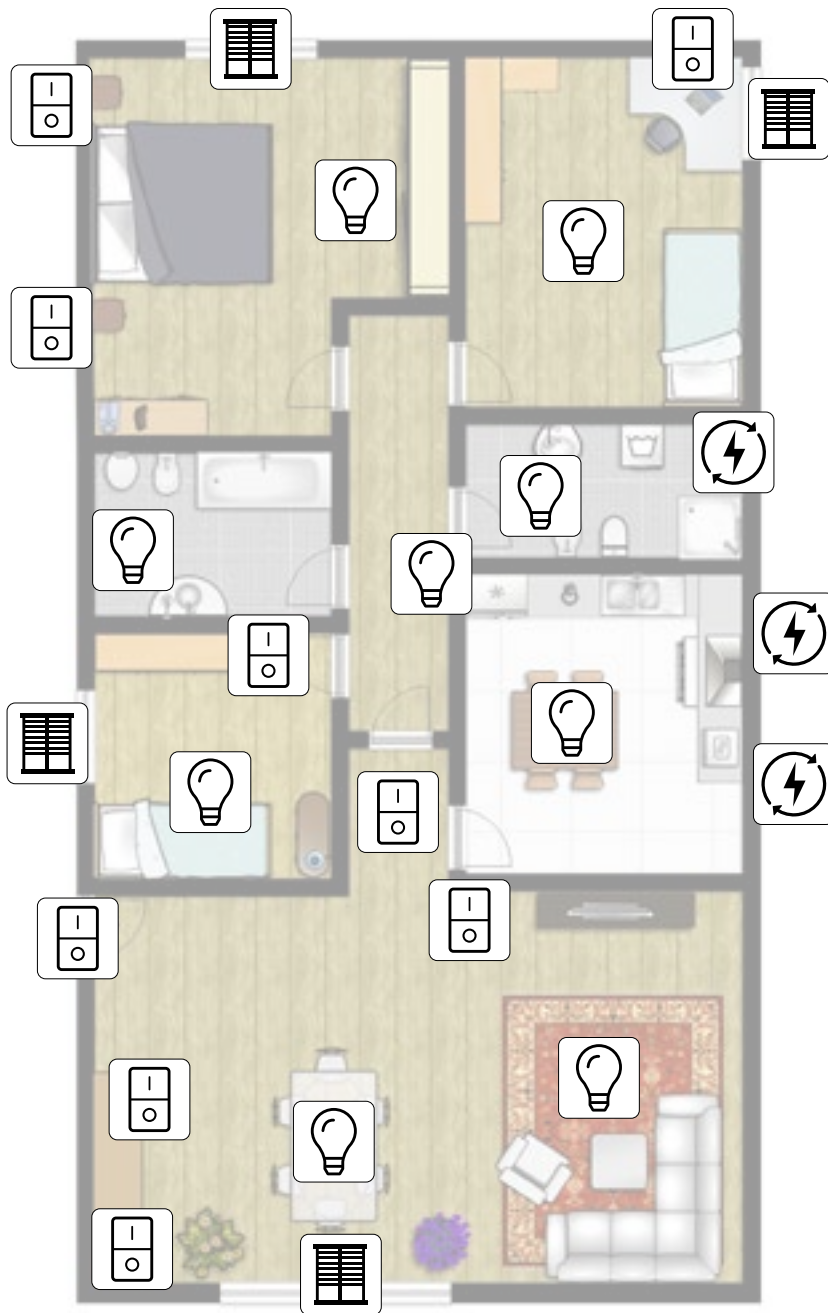



BASIC KIT 04

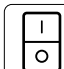

- 9 x  **SWITCH RELAY**
9.000.013
- 9 x  **SWITCH**
9.000.012
- 4 x  **MOTOR ACTUATOR**
9.000.028
- 3 x  **ENERGY MANAGER**
9.000.005

For each ezon.io device you need an ezon.io **Power supply** (code 9.000.033).

If the devices are close together with a single power supply I can control up to 3 of them.

OPTIONAL

Mini Hub (9.000.063)

To access the system remotely or to use your voice assistant "Amazon Alexa®" and "Google Nest®"

If you want to have it installed by our professionals

The ezon.io system can also be managed and programmed through the ezon.io APP, which can be downloaded for free from the App Store and Google Play.

